



INSTRUCTION BULLETIN

No. 9006613
Machine: M30
Published: 08-2010
Rev. 00

NOTE: DO NOT DISCARD the Parts List from the Instruction Bulletin. Place the Parts List in the appropriate place in the machine manual for future reference. Retaining the Parts List will make it easier to reorder individual parts and will save the cost of ordering an entire kit.

NOTE: Numbers in parenthesis () are reference numbers for parts listed in Bill of Materials.

Installation instructions for **kit number 9004672**

SYNOPSIS:

This kit contains the parts needed to replace the front shroud seal on M30 machines. Please follow step-by-step instructions.

SPECIAL TOOLS / CONSIDERATIONS: NONE

(Estimated time to complete: 20 minutes)

PREPARATION:

1. Park the machine on a clean level surface, turn off the machine, remove the key, and set the parking brake.

FOR SAFETY: Before leaving or servicing machine, stop on level surface, turn off machine, and remove key.

2. Open the front shroud.

INSTALLATION:

1. If the existing front cover seal is still on the front shroud, remove the seal and staples from the front shroud.
2. Position the new front shroud seal (1) where the old seal was previously located, hold the seal retainer strip (2) against the seal, and thread the five pan screws (3) through the holes in the retainer strip, through the shroud seal, and into the front shroud.
3. Open and close the front shroud to ensure the newly installed front shroud seal (1) does not prevent the shroud from being closed.

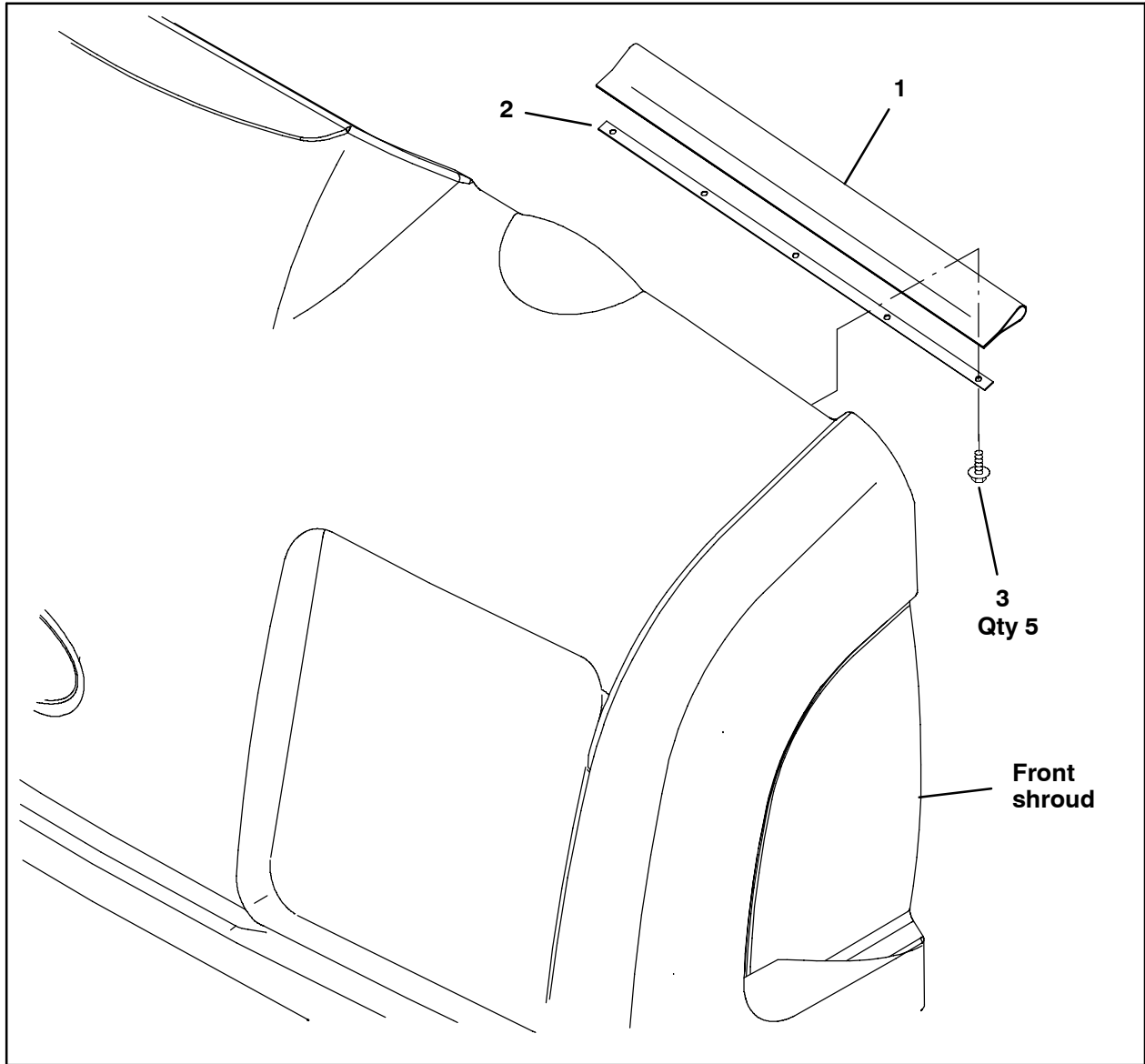

FIG. 1

Bill Of Materials For Seal Kit, Cover, Front, Replmt - 9004672

Ref.	Tennant Part No.	Description	Qty.
▽	9004672	Seal Kit, Cover, Front, Replmt	1
▲	1 1046245	Seal, Shroud, Front	1
▲	2 1046833	Strip, Retainer, Seal	1
▲	3 360943	Screw, Pan, Phl, 10-14 X 0.75, F/ Plstc	5

TENNANT COMPANY
P. O. Box 1452
Minneapolis, MN 55440-1452